

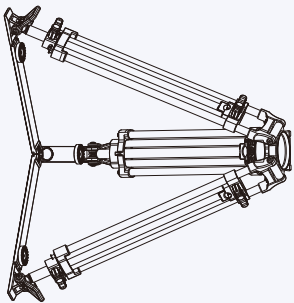

Professional Photographic Equipment

INSTRUCTIONS

BCT Series Professional Video Tripod with 3 Sections



Guangdong SIRUI Optical Co.,Ltd.

Address: The Third Industrial District, Wujiaochan Town, Zhongshan City, Guangdong, China
Tel: 0086-760-889897373 Fax: 0086-760-88207062 Service Hotline: 0086-400-6302299
E-mail: info@sirui-photo.com http://www.sirui.com P.C: 528458



BCT Series Tripod Data Chart

	Section	Max Dia mm/inch	Min Dia mm/inch	Min Hgt mm/inch	Max Hgt mm/inch	Retracted H mm/inch	Weight kg/lb	Load kg/lb
BCT-2003	3	22/0.9	16/0.6	435/17.1	1600/63.0	750/29.5	4.0/8.8	10/22.0
BCT-2203	3	22/0.9	16/0.6	435/17.1	1600/63.0	750/29.5	3.5/7.7	10/22.0
BCT-3003	3	25/1.0	19/0.7	445/17.5	1600/63.0	750/29.5	4.9/10.8	18/39.7
BCT-3203	3	25/1.0	19/0.7	445/17.5	1600/63.0	750/29.5	4.4/9.7	18/39.7

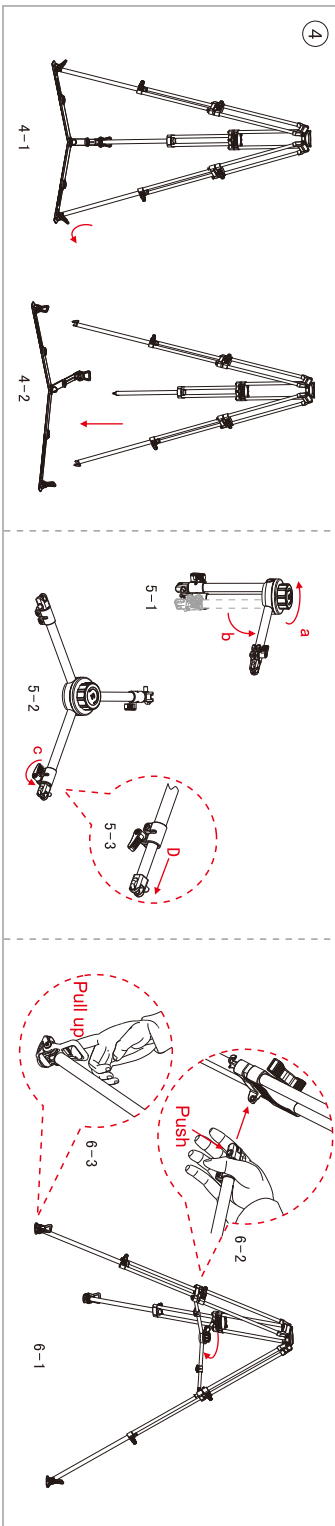
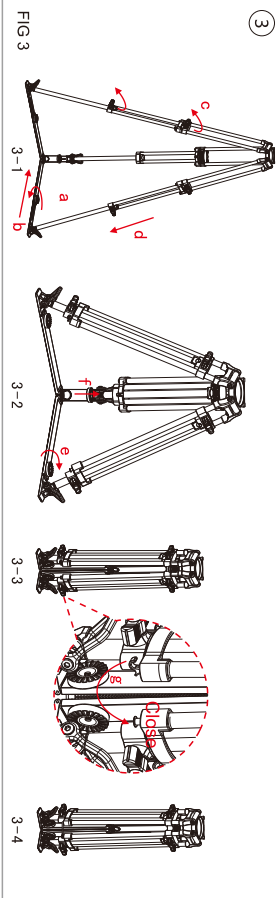
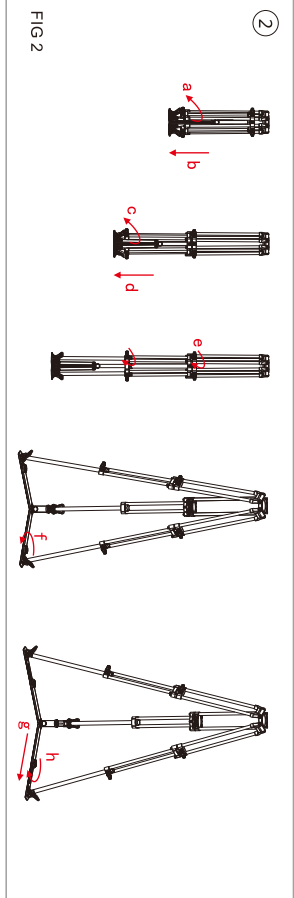
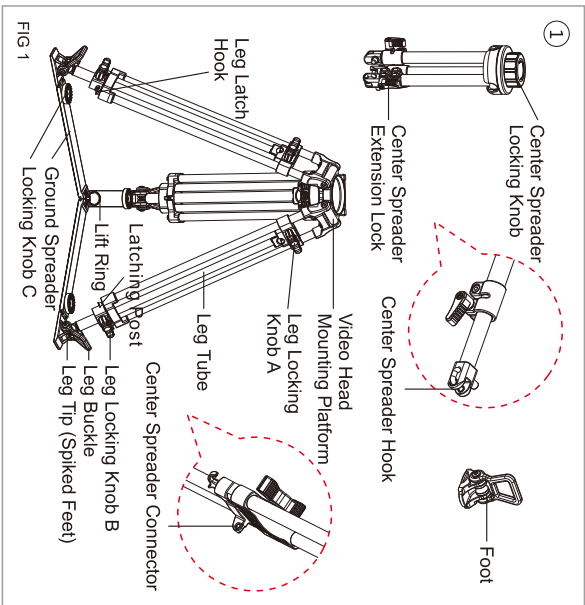

1. Know your tripod

2. Setting up the tripod on a flat, smooth surface

Fully loosen Leg Locking Knob A on all 3 legs, lift up from the Video Head Mounting Platform and re-tighten the locking knobs after the legs have fully extended. Spread the legs apart, until the Ground Spreader is flat on the ground. If additional height is needed, fully loosen Leg Locking Knob B on all 3 legs and follow the same procedure. Loosen Locking Knob C to extend the ground spreader to the desired position and re-tighten Locking Knob C (see fig. 2).

3. Retracting the tripod

Loosen the 3 Locking Knobs C, retract the Ground Spreader and re-tighten the Locking Knobs. Fully loosen the 3 Leg Locking Knobs A and B (see fig. 3-1), push down from the top of the tripod to collapse the legs, then re-tighten each locking knob. Pull up the Lift Ring in the middle of the Ground Spreader (see fig. 3-2), while holding the tripod and the three legs will move together (see fig. 3-3). Pull out the Leg Latch Hook and attach it onto the Latching Post on the adjacent leg to keep the tripod legs closed (see fig. 3-4).

4. Setting up the tripod on uneven ground

- 1 Open the tripod (see fig. 4-1) and remove the Ground Spreader by pulling the Leg Buckle up and away from the leg (see fig. 4-2).
- 2 Loosen the Center Spreader Locking Knob by turning counter-clockwise. The three arms attached to the center spreader can be moved up to 90° (see fig. 5-1); loosen the Center Spreader Extension Lock and the center arms can be extended (see fig. 5-2, 5-3).
- 3 Place the end of the Center Spreader next to the Center Spreader Connector, push the button on the Center Spreader Hook, position the hook onto the Center Spreader Connector and release. Tighten the Center Spreader Extension Lock (see fig. 6-2).
- 4 If you do not want to use the spikes, place the foot between the two spikes on the bottom of the leg. Pull the Buckle up and towards the leg and hook it onto the groove at the end of the leg (see fig. 6-3). You can adjust the legs to the desired angle by loosening the Center Spreader Extension Lock and extending the arms as needed. Make sure that the longer section of the foot is facing away from the tripod.

Attention

Do not exceed the recommended load limit of the tripod head and/or tripod. (Please refer to product specifications.)

Please make sure that the locks are securely tightened when in use.

This product should not be used in environments that exceed the following conditions (40 ~ +100°C/40 ~ +212°F). And, when used in damp, dirty or dusty environments, please clean and dry thoroughly after use, to assure proper functioning in the future. It is not recommended to expose this product to saltwater. If exposed, please clean with mild soap and warm water and towel dry.

Please keep from high temperatures and direct exposure to bright sunlight for extended periods of time.

Please do not leave the equipment alone in a public place, which can be an inconvenience or hazard to others.

To protect your camera and video gear, please remove it from the tripod/video head when transporting from place to place.

Please use a soft towel with warm water and mild soap to clean the locking system and gliding parts when necessary. Towel dry before storing the tripod.

Under most situations, there is no need to lubricate any parts of this product. The addition of most lubricants will gum up the mechanisms and reduce their normal gliding characteristics. Please call or email us if you have any questions or special needs.

Please keep this product away from all electrical power sources.

Note: A separate video head with a 75mm (BCT2003/2203) or 100mm (BCT3003/3203) ball and leveling base is required to attach your video camera onto the BCT Video Tripod.

Specifications are subject to change without notice.

WARRANTY CARD INFORMATION

Dear SIRUI Customer,
Thank you for your purchase of SIRUI Professional Products!
SIRUI warrants that your purchase is free from defects in materials and workmanship under normal use during the Limited Warranty Period. The Warranty begins on the original date of purchase on your sales receipt, and is not transferable. If service is required, a copy of the sales receipt must be included with an explanation of the problem.

Product	Warranty Length
Tripods / Monopods / Accessories	6 years
Humidity Control Cabinet (Cabinet)	
Humidity Control Cabinet (Electronics)	3 years

Model: _____ Date: _____

Store: _____ Serial Number: _____

Warranty coverage can differ from region to region.

Please see the contact information below for product registration, information and service for the region the product was purchased in.

SIRUI 6 (six) Year Limited Warranty (3 Year Warranty for Electronic Parts). This warranty shall be limited to repair, adjustment and/or replacement at SIRUI or its authorized distributors option, of defective parts, free of charge (except the cost of transportation to the distributor/service center). Responsibility is limited to the actual cost of the item. Call or Email with questions and service before sending any product to the center in your region. Below is a listing of contact information for Product Registration, Service Inquiries and Questions. SIRUI will not be responsible for expenses or inconveniences, or consequential damages to equipment, or by breach of any expressed or implied warranties.

Limitations:

This warranty is not transferable.

This warranty covers all defects encountered in normal use of the equipment and does not apply in the following cases:

1. If the equipment has been serviced by other than an authorized SIRUI Service Center.
 2. Any damage to the equipment is due to modification (including but not limited to, the removal of ballhead clamps), overloading, mishandling, abuse, accident, sand, corrosives, water damage" or not following operating instructions.
 3. No valid proof of purchase is provided.
 4. Damage caused by acts of nature (including, but not limited to fires, floods or earthquakes).
- *W Series Waterproof/Dustproof models – Warranty coverage can differ from region to region. Please see contact information below for product registration, information and service for the region the product was purchased in.

Warranty Address and Contact Information:

(Please contact the seller or the local distributor where the product was purchased for warranty issues or questions and before any product is sent.)

1. Guangdong SIRUI Optical Co., Ltd.

The Third Industrial District, Wujiaochan Town, Zhongshan City, Guangdong, China
Tel: 0086-760-889897373 Fax: 0086-760-88207062
http://www.sirui.com E-mail: info@sirui-photo.com
Service Hotline: 0086-400 830 2299

2. SIRUI USA, LLC

Add: 29 Commerce Court Verona, NJ 07044
www.sirui.com
Service: Toll Free 866-373-0829 E-mail: info@sirui.com
FOR PRODUCTS PURCHASED IN THE USA PLEASE SEE:
For full details on USA Warranty Terms and Limitations:
www.sirui.com/warranty.html
To register products: www.sirui.com/product-registration.html

3. Focus Nordic AB

For technical support, service or repairs, please contact:
Sweden: info@focusnordic.se
Denmark: info@focusnordic.no
Finland: info@focusnordic.fi
Iceland: info@focusnordic.is
Latvia: info@focusnordic.lv
Estonia: info@focusnordic.ee
Lithuania: info@focusnordic.lt
Poland: info@focusnordic.pl
www.focusnordic.pl

4. SIRUI Europe GmbH (European Service Center)

Add: Fredericistr.2, 14059 Berlin, Germany
Phone: +49 221 94 99 54-50 E-mail: info@sirui.de
(Please contact the seller or your local distributor for warranty issues.)

5. TSE Imaging BV

Add: Argonne 135 1362AD Almere, The Netherlands
Tel: 020-4541033 8450048 E-mail: service@tse-imaging.nl
(Exclusive Distributor for Netherlands, Belgium, Luxembourg)
www.sirui-photo.nl

6. 대원엔터테인먼트

하계출판 기획지원 및 비즈니스 제공.
서울특별시 중구 남대문로 10, 1층
Tel: 02-762-3304 Fax: 02-774-9903
www.sirui.co.kr loweprokr@gmail.com

图纸名称：思锐BCT系列3节管说明书

物料编号：BCT15-1

制图：彭少章

审核：

批准：